



Stanmore, NSW
113/23 Corunna Road

1
BED

1
BATH

1
CAR



CPS Property
passionately committed

FULLY UPDATED EXECUTIVE ONE BEDROOM APARTMENT IN 'THE CHOCOLATE FACTORY'

Available: 14 October 2023

Initial Lease Period: 6 or 12 months

Inspect: Saturday, 30th of September, 12:20 AM to 12:35 AM

This spacious fully renovated one bedroom residence boasts sun-drenched open plan interiors enjoying an easterly aspect capturing district views across the city skyline. Conveniently situated in the landmark 'Chocolate Factory' complex, this executive split level residence is located moments to buzzing local cafes, bars & eateries, gourmet supermarkets & boutique shopping, with Stanmore Train Station just a short stroll away & regular bus services on your doorstep.

LEASED

Contact: Alistair Lees
0488556634

Type: Apartment

Date Available: 13/10/2023

Bond: \$2400

<https://www.cpsproperty.com.au>

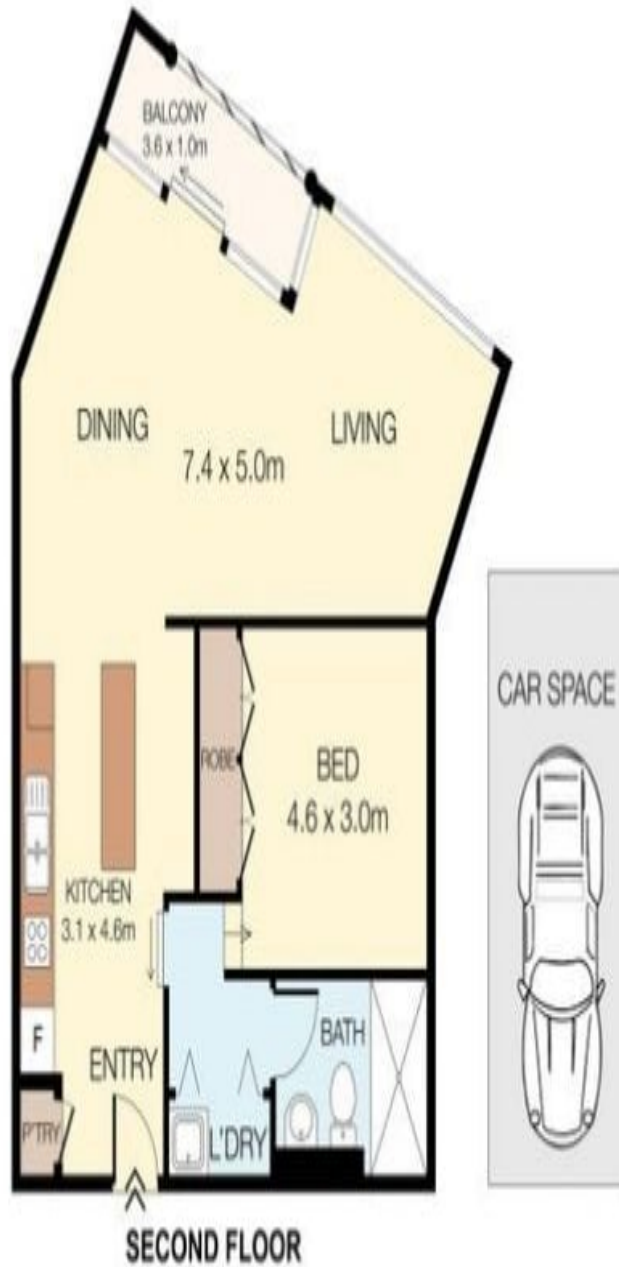

This online document has been prepared as a guide only. Neither the agent, Capper Fry Ltd trading as L'Etalon Newcastle, or the vendor give any warranty as to its accuracy and all parties must rely on their own enquiries. Please refer to the contract for more complete information.

Plans shown are only indicative of layout. Dimensions are approximate.

Stanmore, NSW
113/23 Corunna Road