



**Stanmore, NSW**  
113/23 Corunna Road

**1** BED **1** BATH **1** CAR

**CPS Property**  
passionately committed

### FULLY UPDATED EXECUTIVE ONE BEDROOM APARTMENT IN THE CHOCOLATE FACTORY

Available: NOW

Initial Lease Period: 6 or 12 months

Inspect: By Appointment

This spacious fully renovated one bedroom residence boasts sun-drenched open plan interiors enjoying an easterly aspect capturing district views across the city skyline. Conveniently situated in the landmark 'Chocolate Factory' complex, this executive split level residence is located moments to buzzing local cafes, bars & eateries, gourmet supermarkets & boutique shopping, with Stanmore Train Station just a short stroll away & regular bus services on your doorstep.

### LEASED

**Contact:** Alistair Lees  
0488556634

**Type:** Apartment

**Date Available:** 11/02/2022

**Bond:** \$2200

<https://www.cpsproperty.com.au>

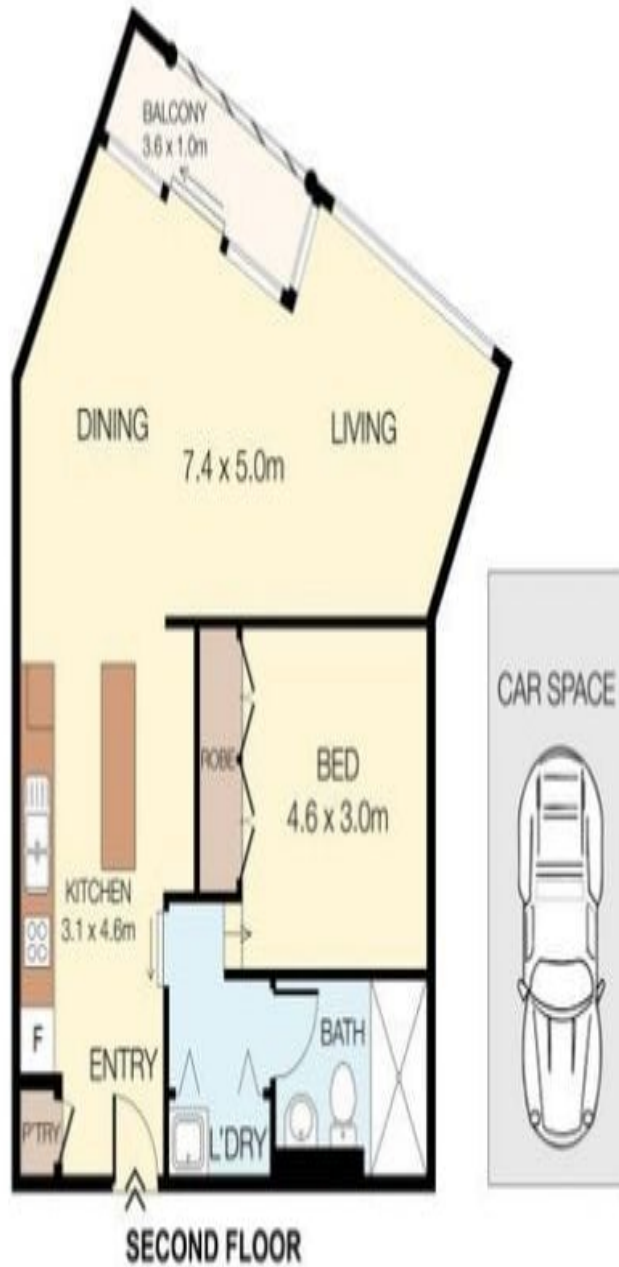

This online document has been prepared as a guide only. Neither the agent, Capper Property Ltd trading as L'Etalon Newcastle, or the vendor give any warranty as to its accuracy and all parties must rely on their own enquiries. Please refer to the contract for more complete information.

Plans shown are only indicative of layout. Dimensions are approximate.

**Stanmore, NSW**  
113/23 Corunna Road