



Killara, NSW
208/657 Pacific Highway

1 BED **1** BATH **1** CAR

CPS Property
passionately committed

LEASED - SATURDAY INSPECTION CANCELLED

Available: LEASED - SATURDAY INSPECTION CANCELLED
Lease Period: 6 or 12 month
Open for Inspection: CANCELLED Saturday 5th Feb 10.00-10.15am.
CANCELLED

LEASED

Beautifully presented brand new one bedroom apartment offering the very best of contemporary living.

- Quiet location
- Spacious living area enjoys pleasant garden outlook
- Caesar Stone kitchen, Bosch stainless steel appliances
- One bedroom with built in wardrobe
- Internal laundry

LEASED

Contact: Jacob O'Neill
0403 042 525

Type: Unit
Date Available: 29/01/2011

Bond: \$1960

<https://www.cpsproperty.com.au>

Apartment 208

1 Bedroom Apartment

657 Pacific Highway Killara NSW 2071

Internal	External	Total
55m ²	11m ²	66m ²

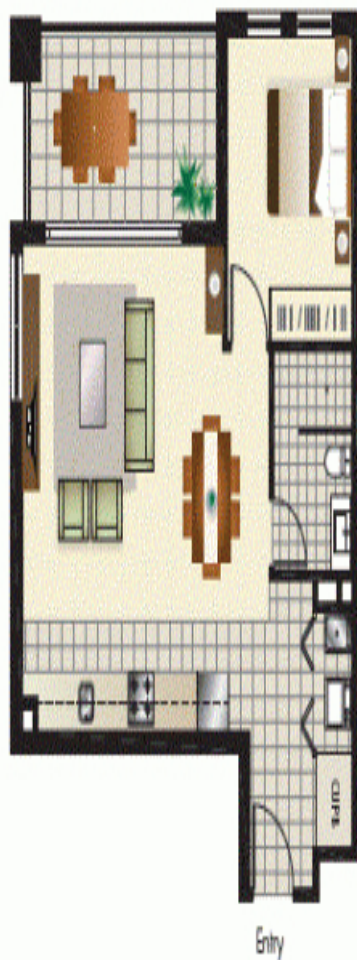

Legal Disclosure: This material was prepared prior to the completion of construction of Killara 657 and is intended as a general introduction to the development. It does not form any guarantee or contract. Dimensions, specifications and fittings are subject to change without notice and all layouts and artist's impressions are indicative only. Prospective purchasers must rely on their own inspection and Contract of Sale.

Plans shown are only indicative of layout. Dimensions are approximate.

www.killara657.com.au

Killara, NSW
208/657 Pacific Highway