



**Guildford, NSW**  
12/3-5 Talbot Street

**1**  
BED

**1**  
BATH

**1**  
CAR

 **CPS Property**  
passionately committed

### AS NEW 1 BEDROOM APARTMENT - CLOSE TO SHOPS & STATION

Just over a year old, this modern as new 1 bedroom apartment has everything you need to maximise your lifestyle.

- Combined Lounge/Dining
- Caesar stone kitchen with stainless steel appliances and dishwasher
- Air conditioning/gas heater port
- 1 oversized bedroom with mirrored built-in wardrobes
- 2 balconies with North/South aspect
- Security flyscreens on balcony doors
- Internal Laundry with dryer
- Conveniently located; 5 min walk to Guildford station/500m to shopping precinct

### LEASED

**Contact:**

**Type:** Apartment

**Date Available:** 25/08/2009

**Bond:** \$1200

<https://www.cpsproperty.com.au>

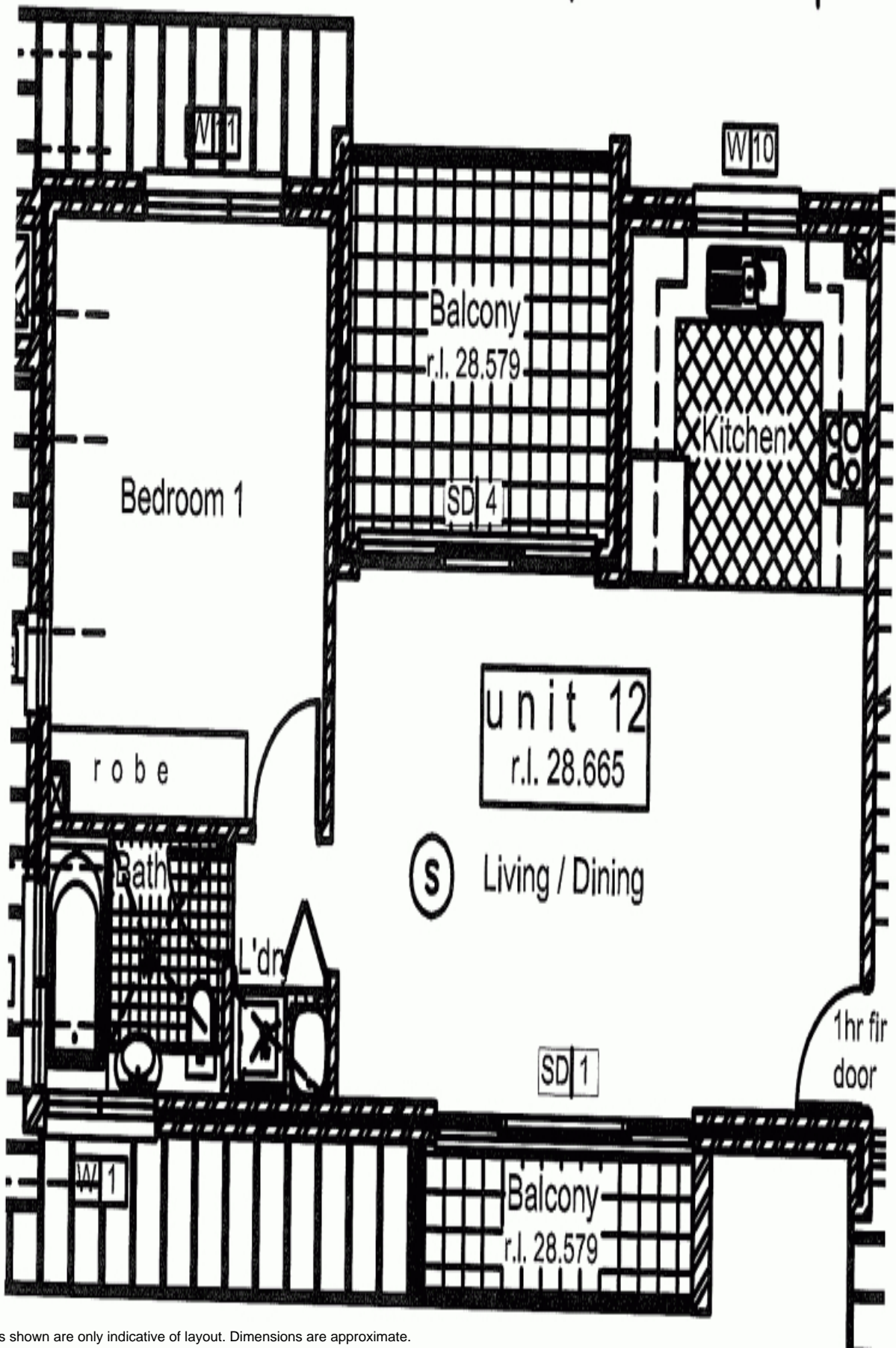

Plans shown are only indicative of layout. Dimensions are approximate.

**Guildford, NSW**  
12/3-5 Talbot Street