



Surry Hills, NSW

53/30-34 Chalmers Street

1 BED
1 BATH
0 CAR

CPS Property
passionately committed

SLEEK URBAN ONE BEDROOM RESIDENCE IN 'CHALMERS CENTRAL' OPEN FOR INSPECTION: BY APPOINTMENT

Available: 26 May 2015

Initial Lease Period: 6 or 12 months

Inspect: By Appointment

LEASED

Contact: Jacob O'Neill
0403 042 525

Type: Apartment

Date Available: 26/05/2015

Bond: \$2400

<https://www.cpsproperty.com.au>

'Chalmers Central' is a collaboration from the same architect and developers who created DeNode, Waterloo Street, Surry Hills - winner of the highest multiple housing award in 2011 from the Australian Institute of Architects. They have again delivered a perfect balance of contemporary design with quality appointments and meticulous finishing and a great location.

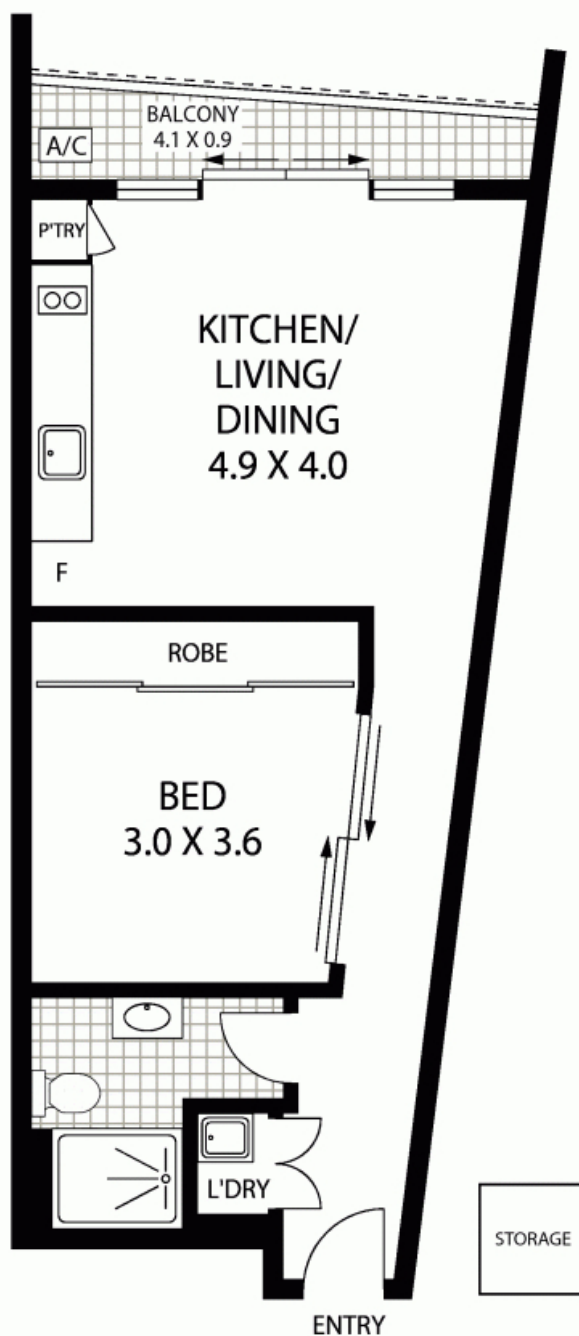

LEVEL FIVE

APPROX : TOTAL INTERNAL AREA :- 45 SQM
 APPROX : BALCONY AREA :- 4 SQM
 STORAGE :- 1 SQM
 TOTAL :- 50 SQM



53/30-34 CHALMERS STREET

SURRY HILLS

Floor Plan Disclaimer: Mind the Gap (mtg) floor plans / site plans are intended as an approximate guide only. No representations or warranties of any nature are given or intended and any person using this information other than as a guide should always rely on their own enquiries. Mind the Gap property marketing services / 1300 133 145 / Photography, Floor plans, Copywriting, Video, Online, Design / www.mindthegap.com.au

Plans shown are only indicative of layout. Dimensions are approximate.

Surry Hills, NSW
 53/30-34 Chalmers Street